

**SURFACE PROCESSING**

mvt AG offers a comprehensive, economically-priced range of sapphire nozzles for the most varied of applications in the field of surface processing. All of our nozzles consist of a stainless steel nozzle body with a sapphire orifice. Their special design gives them a high degree of stability and safety. Special designs and customer-specific solutions are available on request.

**PROPERTIES AND ADVANTAGES**

- ▶ Long lifetime
- ▶ Consistent jet quality
- ▶ Precision cutting accuracy
- ▶ Narrow cut width
- ▶ High cutting performance
- ▶ Longer lifetime of focusing tube
- ▶ Excellent price-to-performance ratio
- ▶ Swiss quality

**CUSTOMER BENEFITS**

- ▶ High productivity
- ▶ Minimal downtime
- ▶ Cost-effective manufacturing
- ▶ High quality standard
- ▶ Expert advice
- ▶ Reliable service

**APPLICATIONS**

- ▶ Automotive and aircraft industry
- ▶ Construction
- ▶ Mining
- ▶ Chemistry
- ▶ Iron, steel and metal industry
- ▶ Energy
- ▶ Drink
- ▶ Glass, porcelain and ceramics industry
- ▶ Wood industry
- ▶ Local firms
- ▶ Agriculture
- ▶ Machinery and Apparatus
- ▶ Food Processing
- ▶ Offshore Operations
- ▶ Shipbuilding
- ▶ Transportation
- ▶ Pulp and Paper Industry
- ▶ Cement and Concrete Industry

Max. 3000 bar

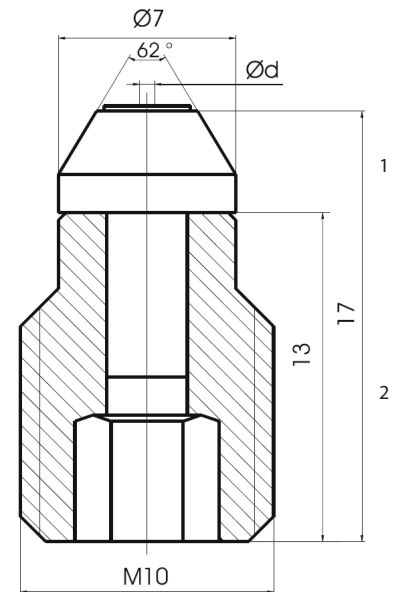

1. Nozzle

2. Assembly screw (Stainless)

Nr 10099

## PERFORMANCE

Nozzle size in U.S. Gal / min at 40 psi	Nozzles Ød mm	Pressure in bar							
		200	500	750	1000	1500	2000	2500	3000
		Density of water							
		kg/m <sup>3</sup>	kg/m <sup>3</sup>	kg/m <sup>3</sup>	kg/m <sup>3</sup>	kg/m <sup>3</sup>	kg/m <sup>3</sup>	kg/m <sup>3</sup>	kg/m <sup>3</sup>
		1010.028	1020.675	1029.36875	1037.9	1054.475	1070.4	1085.675	1100.3
		l/min	l/min	l/min	l/min	l/min	l/min	l/min	
0002	0.10	0.064	0.100	0.122	0.141	0.171	0.196	0.217	0.237
0003	0.125	0.100	0.157	0.191	0.220	0.267	0.306	0.340	0.370
0004	0.15	0.143	0.226	0.275	0.316	0.385	0.441	0.489	0.532
0006	0.175	0.195	0.307	0.375	0.431	0.523	0.600	0.666	0.725
0008	0.20	0.255	0.401	0.489	0.563	0.684	0.784	0.870	0.946
0012	0.25	0.399	0.627	0.764	0.879	1.068	1.224	1.359	1.479
0018	0.30	0.574	0.903	1.101	1.266	1.538	1.763	1.957	2.130
0024	0.35	0.781	1.229	1.498	1.723	2.094	2.400	2.664	2.899
0031	0.40	1.020	1.605	1.957	2.251	2.735	3.134	3.479	3.786
0040	0.45	1.291	2.031	2.477	2.848	3.461	3.967	4.403	4.792
0049	0.50	1.594	2.507	3.058	3.517	4.273	4.897	5.436	5.916
0059	0.55	1.929	3.034	3.700	4.255	5.170	5.925	6.578	7.158
0071	0.60	2.296	3.611	4.404	5.064	6.153	7.052	7.828	8.518
0083	0.65	2.694	4.238	5.168	5.943	7.221	8.276	9.188	9.997
0096	0.70	3.125	4.915	5.994	6.892	8.375	9.598	10.655	11.595
0110	0.75	3.587	5.642	6.880	7.912	9.614	11.018	12.232	13.310
0126	0.80	4.081	6.419	7.828	9.002	10.939	12.536	13.917	15.144
0142	0.85	4.607	7.247	8.838	10.163	12.349	14.152	15.711	17.096
0159	0.90	5.165	8.124	9.908	11.394	13.844	15.866	17.614	19.166
0177	0.95	5.755	9.052	11.039	12.695	15.425	17.678	19.625	21.355
0196	1.00	6.377	10.030	12.232	14.066	17.091	19.588	21.746	23.662

## INSTRUCTIONS

During manual operation of high-pressure spray guns and lances, which may be included recoil force in the longitudinal axis of the spray device may not exceed 250N!

If the recoil force is 150N, has been working with a body support!

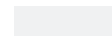
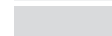
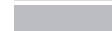
	< 150 N
	< 250 N
	> 250 N